

Product Features

- Tiny 3/4" (19.25mm) round dual board
- 400 TVL
- 1/3" CCD
- 0.3 lux
- Low power
- Ideal for applications such as pipe inspection

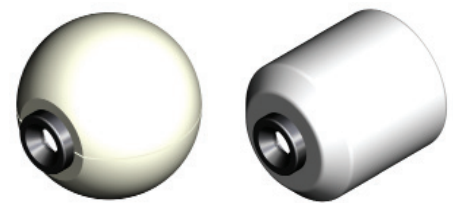
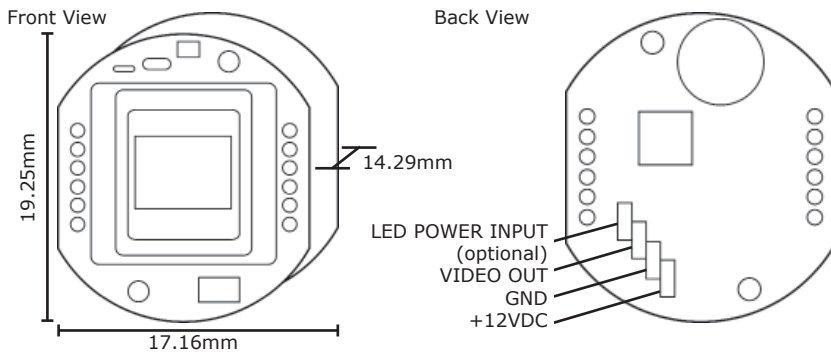

Lens & Housing Possibilities for OEMs

Technical Specifications

	20RD8 NTSC	21RD8 PAL
Electrical		
Image Sensor	1/3" IL CCD	
Active Pixels (HxV)	512 x 492	512 X 585
Horizontal Resolution	> 330 (TVL)	
Vertical Resolution	400 (TVL)	
Sensitivity	> 0.3 Lux (30 IRE) F1.2, 3200K, lens transmission 85%, scene reflection 75%	
Signal To Noise Ratio	> 46 dB (AGC off)	
Gamma	0.45 (default)	
Gain Control	Automatic 26 dB (default)	
Synchronization	Internal	
White Balance	Default auto 2300 - 7500K, fixed white balance to color temperature or light source	
Scan Mode	Interlaced (default)	
Contour Enhancement	Default on	
Iris Controls	Electronic (default)	
Video Output	1Vp-p 75ohms (AC coupled)	
Power Supply	12VDC (+/- 10%)	
Power Consumption	< 0.8W	

Environmental

Operating Temperature	-05°C ~ 40°C (23°F ~ 104°F)
Operating Humidity	20 to 95%RH
Storage Temperature	-10°C ~ 50°C (14°F ~ 122°F)
Storage Humidity	Up to 98% RH
Lifetime	MTBF >150000 hours

Mechanical

Dimensions W x H x D	17.16mm x 19.25mm x 14.29mm (.676" x .758" x .562")		
Interfaces	3 Wire	12VDC	(Red AWG26)
		Video Out	(Yellow AWG26)
	Optional	Ground	(Blue AWG26)
		I/O power for external system LEDs	(White AWG26)
OLP/IR Filter	Single layer 0.81mm (depth)		

Accessories

Optional	LED	I/O available for special lighting options
	Housing	Can be contracted
	Heat sink	Can be contracted
	B&W model	20RD3 (same specs as 20RD8 except B&W output)