

Technical Specifications

Sensing Area		1/3"
Focal Length		5.0mm
Aperture		F13
Back Focal Length		5.5mm
Field of View (D x H x V)		70.5° x 56.5° x 42.5°
Operation	Iris	Fixed
	Focus	Manual
Distortion		-11.8%
Minimum Object Distance		40cm
Mount		M-12
Dimensions (Ø x L)		Ø 12mm x 4.7mm
Weight		2.0g

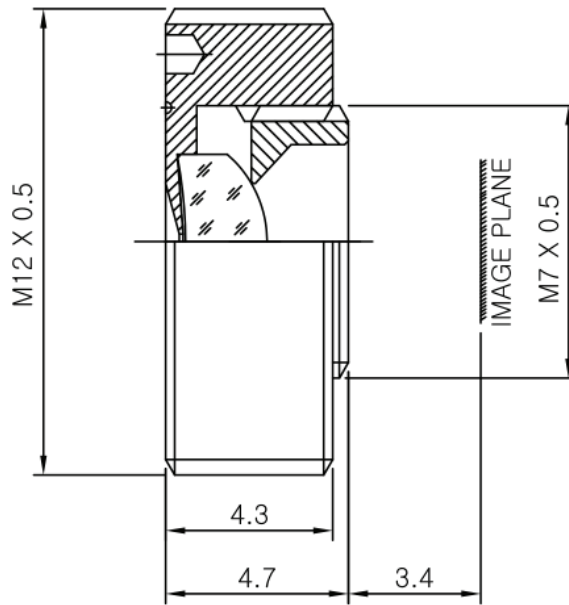

Tolerance : ±0.4mm